

World's #1

Auto Power-Folding Golf Trolley

Plegado automático- cortinilla de Golf / Selbst ausklappbarer Golf Trolley
Carrello da Golf elettrico auto-pieghevole / automatisk sammenklapning golfvogn
sjálfvirkur leggja saman golf körfu / automatisk folde golf cart
automatisk vikning golf caddy / automaattinen taitto golfkärry
Chariot de golf repliable électrique

Revolutionary Technology

GolferPal

– Easy Pal –

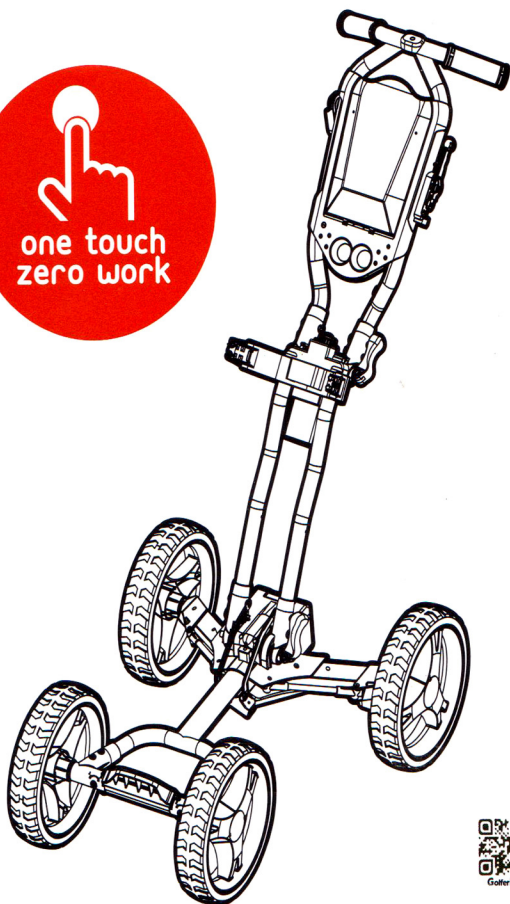

www.golferpal.com

GolferPal

To avoid unintended damage to the product and injury to the user, please consult this user manual before using your Easy Pal push trolley. Please carefully read the following safety instructions listed.

CAUTION!!

- This trolley is not a toy; it is intended for adult use only.
- This trolley is designed to carry golf bags only. Maximum weight limit: 40 lbs.
- For emergency stop while the trolley is in motion, push the red button once more. Do not try to stop it with your hands or objects while it is in motion.
- Please allow 20 minutes' break after folding/unfolding the trolley 10 times continuously.
- DO NOT adjust the angle of the lower parts of the trolley. This will result in damaging the gear box.

Table of Content

- A. Reset to default setting
- B. Parts diagram
- C. Battery
- D. Folding/Unfolding
- E. Bag Placement
- F. Carrying the trolley
- G. Emergency fold/unfold
- H. Brake systems
- I. Console
- J. Umbrella holder
- K. Cup holder
- L. Warranty
- M. Trouble shooting

Warning: Do not adjust the angle for lower part.

A. Reset to Default Setting

Due to the trolley's memory system, every time you perform an emergency fold/unfold, you **MUST** reset the trolley to its default setting before you switch to its auto fold/unfold mode. Otherwise, the trolley will not function.

Reset to default setting:

- Step 1. Manually unfold this trolley to an open position, then lock the upper and lower levers.
- Step 2. Turn the power dial to "fold"
- Step 3. Push the red power button to automatically fold the trolley.
- Step 4. The trolley has been reset.



B. Parts Diagram

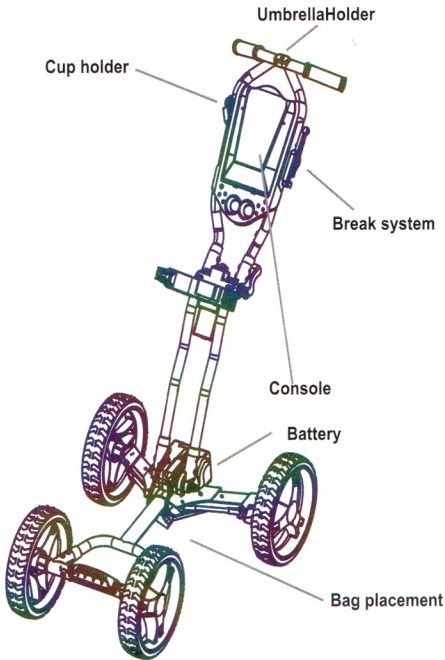

C. Battery

For maximum battery use, it is recommended that the battery be fully charged before first time use. A fully charged battery can be used up to 30 times (fold/unfold=1 time). After approximately 20 times folding/unfolding, the LED light will flash and you will hear beeps reminding you to recharge your battery. In order to avoid battery drainage, we recommend that you to charge the battery when you hear the beeps.

1. Battery Box Location
2. How to insert the battery
3. Low battery

If the battery is low, the trolley will give a warning beep when the red button is pushed. The trolley can be used 5-10 times after the first warning beep.

4. How to remove the battery
5. How to charge the battery

To charge the battery, connect the battery to the charger.

When charging the battery, an empty/low battery will display a red light. It will display a green light when fully charged.

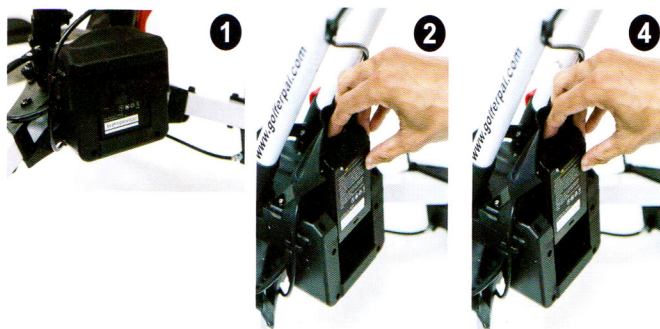

D. Folding/Unfolding

1. Turn the dial to "UNFOLD".
2. When you push the red button, the green light will light up. The trolley will then automatically unfold.
3. To adjust the height of the handle, release the upper lever and adjust the angle of the upper body.
4. Once the handle is adjusted to the desired height, this trolley will keep this height in memory.

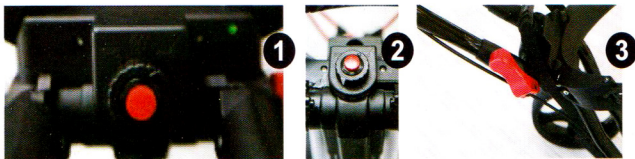

Folding

1. Keep the golf bag holder straps folded inward
2. Turn the dial to "FOLD"
3. When you push the red button, the green light will light up. The trolley will then automatically fold. (show picture)
4. After the trolley has folded, turn the dial back to "OFF".



E. Bag Placement

1. Adjust the strap length
2. Place the golf bag on the trolley
3. Tie the strap



F. Carrying the trolley

To carry the trolley, use the carry strap to pick it up.
ATTENTION!!

Do not attempt to pick up the trolley by its handle.
This will damage to the gear box.



G. Emergency folding/unfolding:

This trolley is designed to be used automatically. Emergency fold/unfold should only be used when the battery is completely out of power. We recommend always keeping this trolley in its auto fold/unfold mode.

Emergency Folding:

1. Release the upper and lower levers, then fold the trolley.
2. After folding the trolley, lock the upper and lower levers.

Emergency Unfolding:

1. Release the upper topper and lower levers, then unfold the trolley.
2. After unfolding the trolley completely, lock the upper and lower levers.

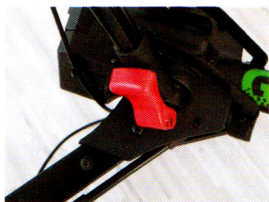

H. Brake Systems

Braking

Push the brake lever down.

Releasing

Pull the brake lever up.

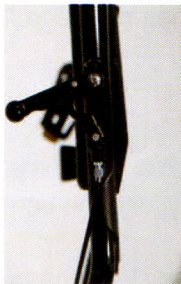

I. Console



J. Umbrella Holder



K. Cup Holder



L.Warranty

USA

One year parts and labor

EU & UK

2 years legal warranty

Trouble Shooting

- If there is no reaction while pressing the red button, check your battery. Recharge and make sure the battery is inserted into the slot properly.
- If the trolley does not brake, adjust the brake by tightening the screws



Q and A:

Q: I accidentally grabbed the handle instead of the strap while it was folded, causing the trolley to be set in a strange position.

A: Simply unfold manually, then fold/unfold automatically once and it will return to normal.

GolferPal

– Easy Pal –