

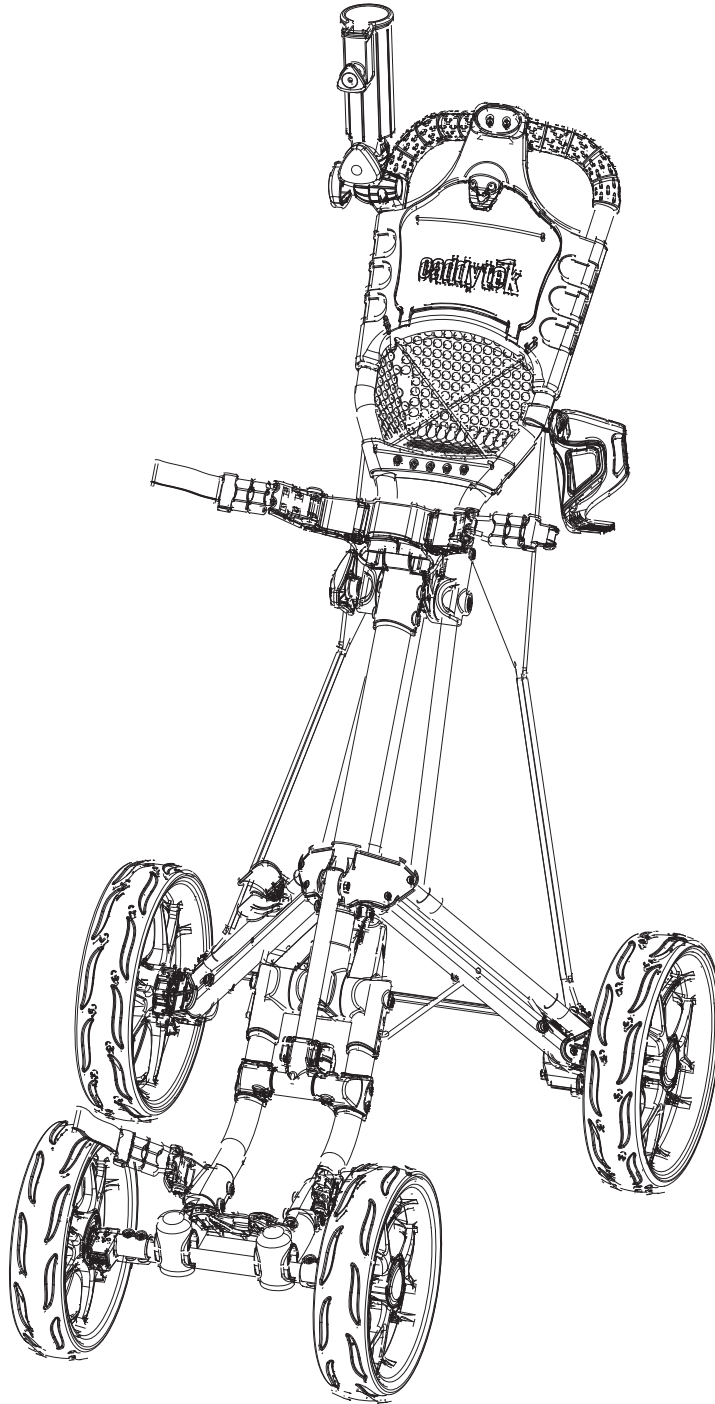

One-click folding 4-wheel golf push cart

Model: CaddyCruiser ONE V3



User Manual

CaddyTek Inc.
20153 Paseo Del Prado
Walnut, CA 91789, USA
Tel: 909-895-6478
www.caddytek.com
Service/Technical support: 800-630-0968

WARNING:

FOR YOUR OWN SAFETY, PLEASE REVIEW THESE WARNINGS AND KEEP THIS USER GUIDE FOR FUTURE REFERENCE.

- Before using this golf cart, please read and understand the important instructions and warnings in this user guide.
- AVOID INJURY by always following the instructions carefully.
- AVOID INJURY by keeping clear of moving parts while adjusting, folding or unfolding this cart.
- ALWAYS make sure the cart is fully extended and locked before use.
- ALWAYS make sure the cart is folded and locked properly before lifting or transporting.
- ALWAYS use the brake when parking the cart.
- DO NOT run while using this cart.
- DO NOT use accessories other than those designed specifically for this cart.
- Keep hands and fingers away from moving parts or sliding sections of the cart

Package contents:

1. The main frame of the cart
2. Two front wheels 26.6 cm (10.5 in.) and 2 rear wheels 29.2 cm (11.5 in.)
3. Umbrella holder
4. Basket (pre-installed on the cart)
5. Drink holder
6. This user manual
7. Hangtags on the handle
8. Tools for adjustment

In case any of the above items are missing or damaged, please call 909-895-6478 or email service@caddytek.com to report.

Parts identification:

- A: PVC handle grip
- B: Scorecard holder assembly
- C: Handle frame
- D: Upper bag holder bracket assembly
- E: Adjustable handle mechanism
- F: Main connecting rod
- G: Main frame
- H: Leg bracket
- I: 2 holes right leg frame
- J: 4 holes leg frame
- K: 2 holes left leg frame
- L: Left stabilization bar
- L1: Right stabilization bar
- M: Footbrake assembly
- N: Left rear wheel holder
- N1: Right rear wheel holder
- O: Holding slot for folded cart frame
- P: Supporting cable
- Q: Sub-connecting rods
- R: Front wheel fork assembly
- S: Rear wheel assembly
- T: Lower bag holder bracket assembly
- U: Front wheel lock mechanism
- V: Front wheel assembly
- W: Umbrella holder base
- X: Umbrella holder
- Y: Basket with cooler
- Y1: Handle mesh net
- Z: Drink holder
- Z1: Umbrella holder storage rack

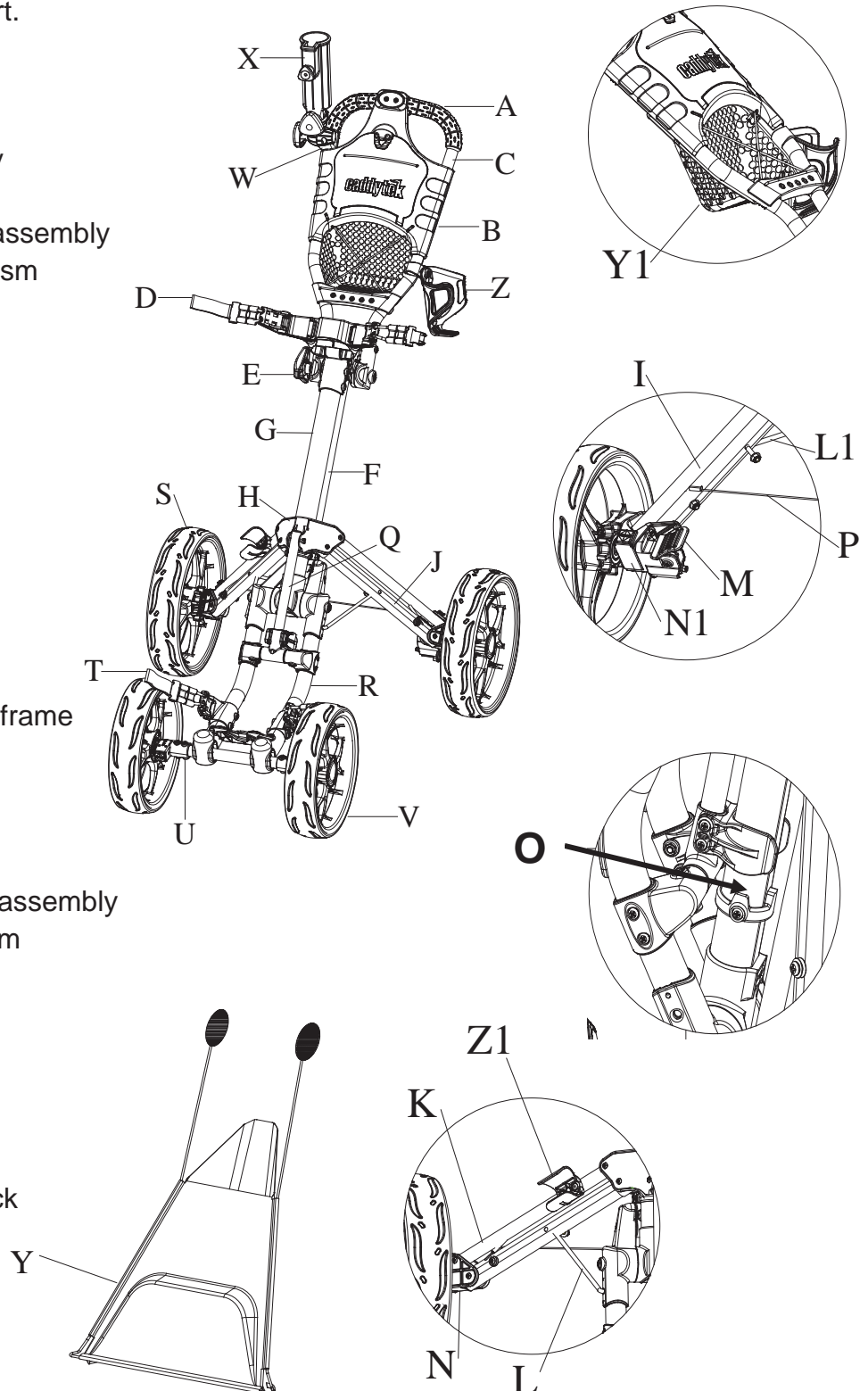

Extending the cart

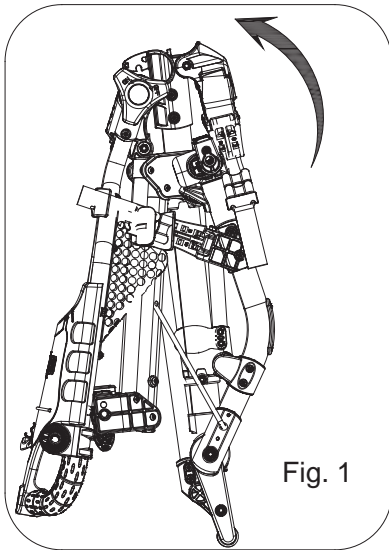

Fig. 1

Lift the upper bag bracket as shown in Fig. 1.

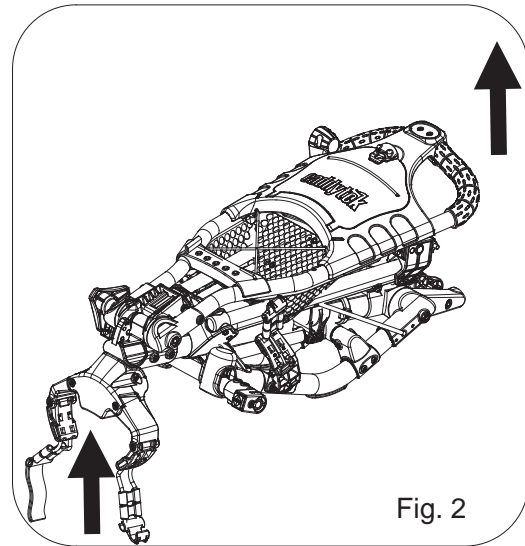
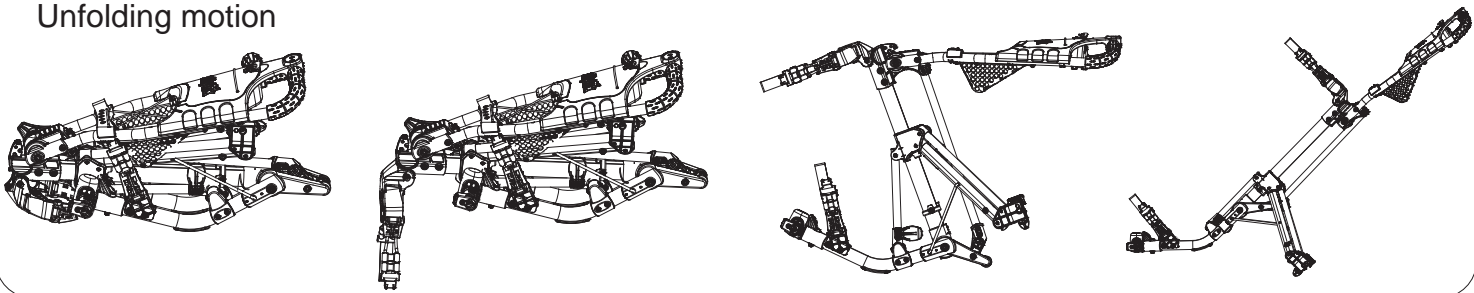

Fig. 2

Simply pull the handle and upper bag bracket as shown in Fig. 2 to extend the cart. (Shake the cart slightly to release the main frame from the holding slot if necessary.)

Unfolding motion



Install wheels

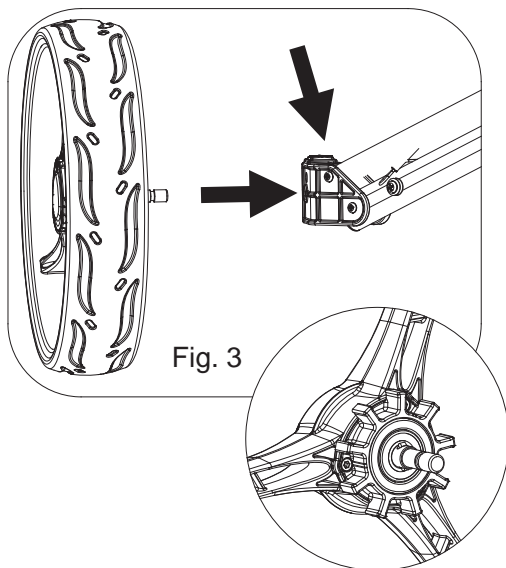

Fig. 3

Press the red bottom on the leg frame and insert the wheels as shown in Fig. 3 to install the rear wheels.

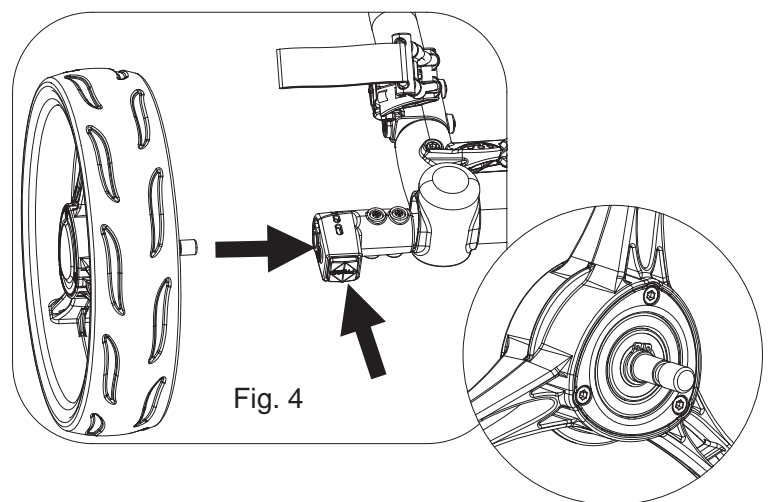

Fig. 4

Press the red bottom on the front wheel axel and insert the wheels as shown in Fig. 4 to install the front wheels.

Folding the cart

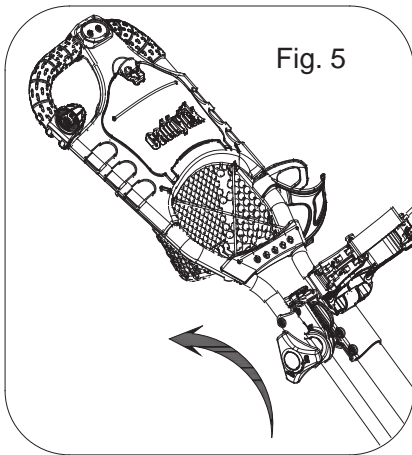

Fig. 5

Turn the red knob as shown in Fig. 5 to release and tighten the handle.

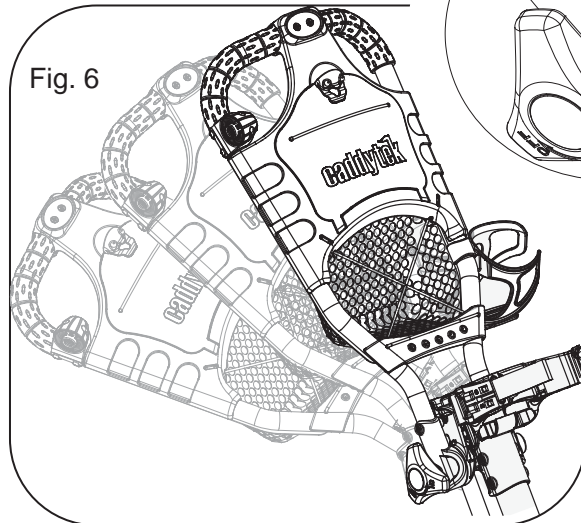

Fig. 6

To achieve the optimal folded size, adjust the handle to the 2nd highest location marked by the small label near red knob as shown in Fig. 6.

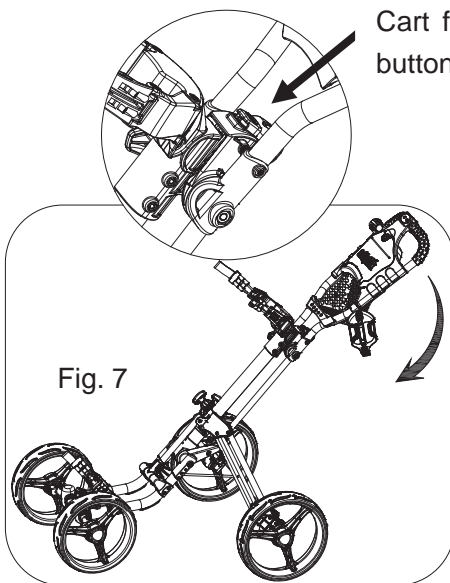

Fig. 7

Cart folding red button

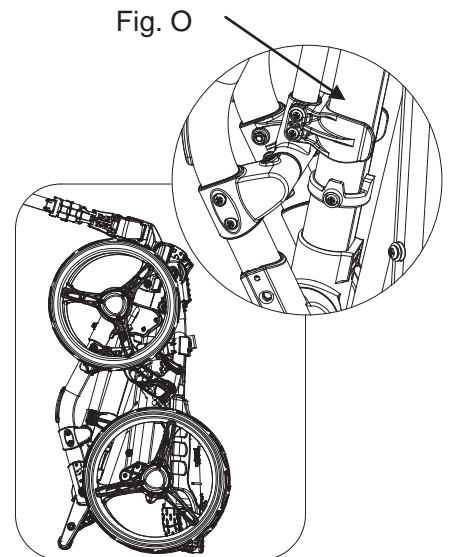
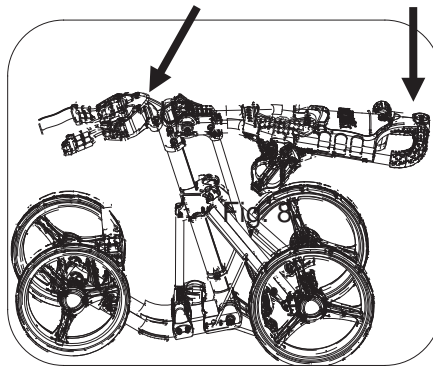

Fig. 8

Press the red folding button and push the handle downward as shown in Fig. 7 and Fig. 8 to fold the cart till the main frame clicks into the holding slot as in FIG. 9.

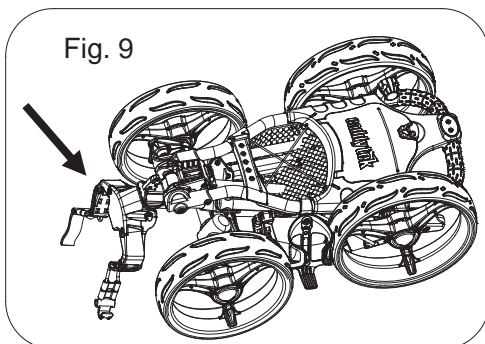

Fig. 9

Push the upper bag bracket downward as shown in Fig. 9.

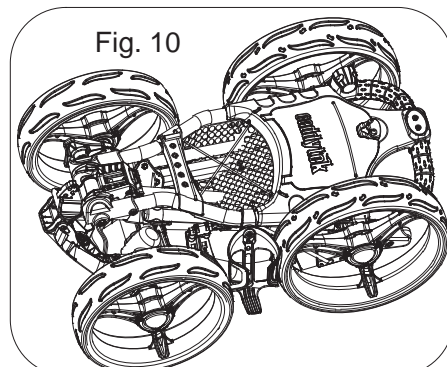

Fig. 10

Fig. 10 shows the cart is folded.

Install umbrella holder

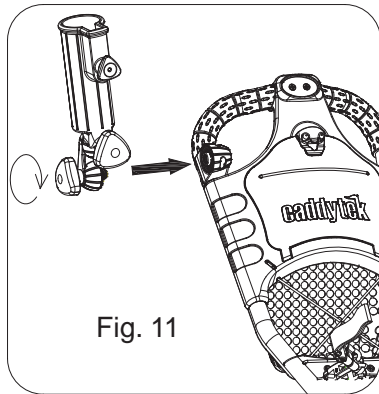

Fig. 11

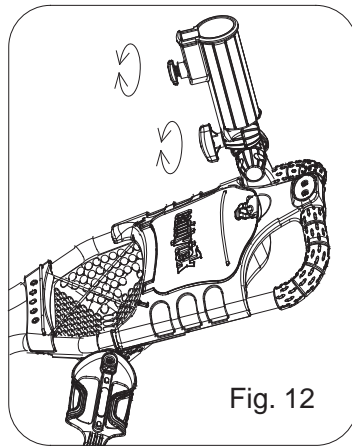

Fig. 12

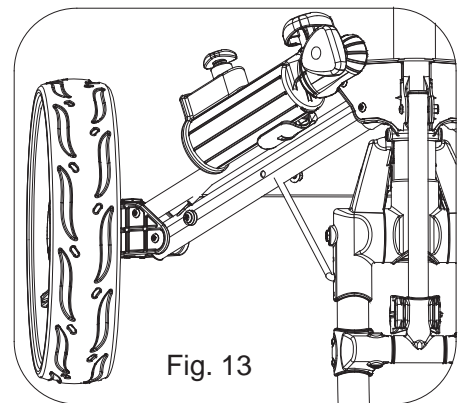

Fig. 13

To put in use:

Simply attach the umbrella holder onto the cart as in Fig. 11 & 12.

To store:

Attach the umbrella holder to the storage rack on the right leg frame as in Fig. 13.

Use the brake

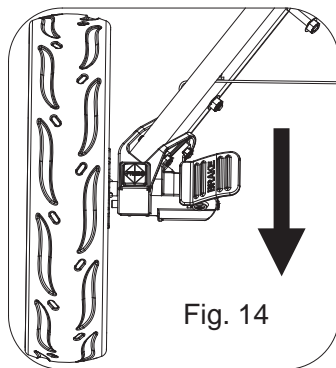
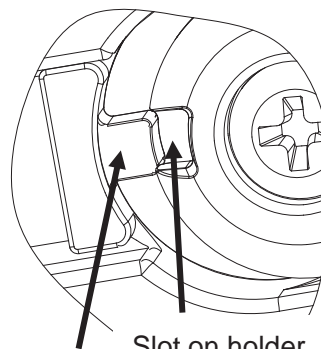
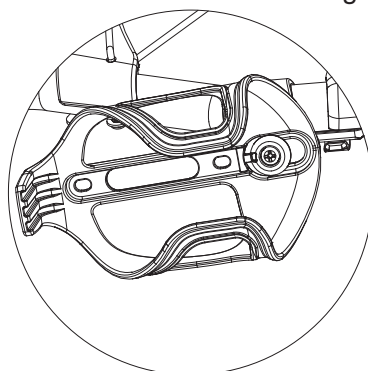

Fig. 14

Press the brake pedal to brake and push again to release as Fig. 14.

Install drink holder

Fig. 15



Fixed block on base notch

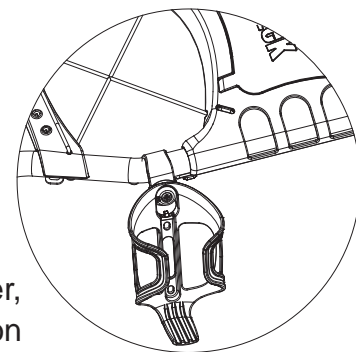

When installing the drink holder, align the smallest part of the slot on the holder with the fixed blocks. Then pull horizontally to fit the holder on the base.

Front wheel alignment

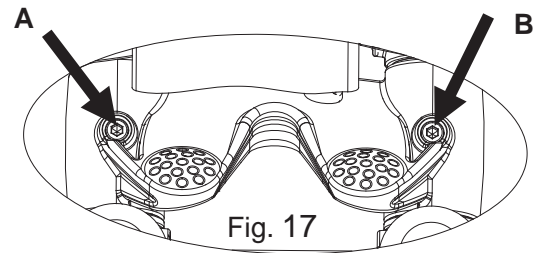
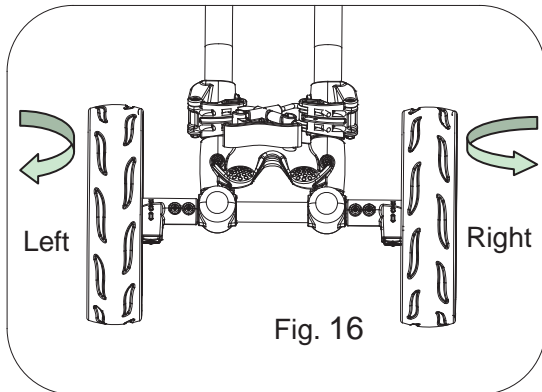

Alignment adjusting screws A/B



Hex wrench

If the cart veers to the left, please use the hex wrench to turn screw A counterclockwise and Screw B clockwise to adjust the alignment.

If the cart veers to the right, please use the hex wrench to turn screw A clockwise and screw B counterclockwise to adjust the alignment.

Bag holder strap adjustment

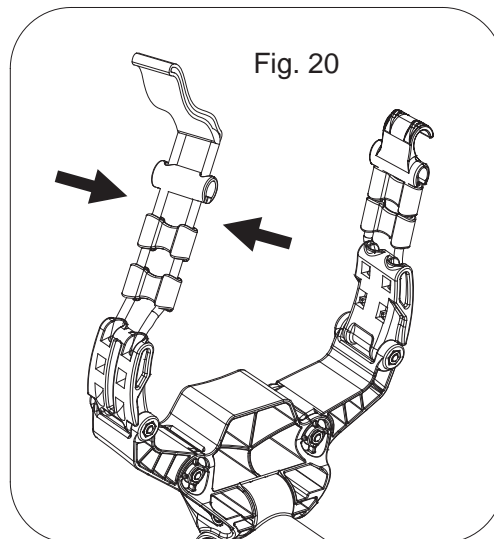
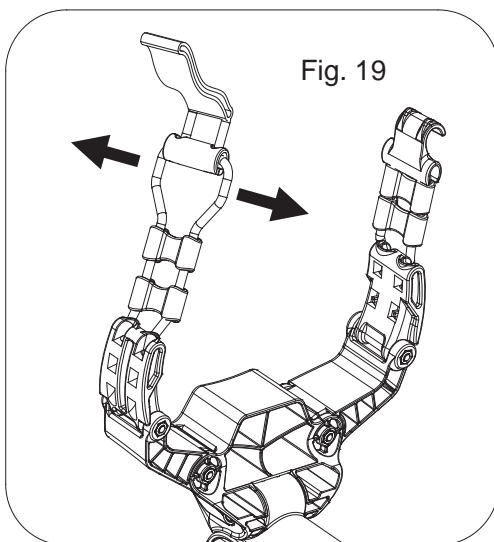

Refer to Figs. 19 and 20:

1. Pull the elastic strap out of the strap buckle as in Fig. 19.
2. Adjust the strap to desired length.
3. Push the elastic strap back to the strap buckle as in Fig. 20.

WARRANTY

CaddyTek Inc. warrants its products to be free of defects and workmanship for one year from the date of purchase. We will either repair or replace defective products at our option.

Normal wear and fading of products is not considered a manufacturer's defect. This warranty does not apply to claim of damage to items used in connection with CaddyTek Inc. products. In the case of deterioration due to normal use we will repair the item for a normal charge. CaddyTek Inc. is the sole judge of any claim or warranty.

For customers in North America, please contact CaddyTek Inc. for the service. For customers outside of North America, please either contact your dealer for the warranty service or you are welcome to contact CaddyTek Inc. directly.

PRODUCT REGISTRATION

I have read and understand this product's operation and warranty, and wish to record my purchase:

Model: _____

Name (Mr./Mrs./Ms.): _____

Address: _____

City: _____ Province: _____ Postal Code: _____

Tel: _____ Email: _____

Date of Purchase : _____ Name of Store/Dealer: _____

Rounds of Golf per Month: _____ H'CAP _____

Signed: _____ Date: _____

Failure to return this card may result in delayed response to your warranty claim

Stamp

CaddyTek Inc.

20153 Paseo Del Prado

Walnut, CA 91789
USA

You can also register your Golf Cart on www.caddytek.com

